

Six Anchor Technique

STEP 1

V

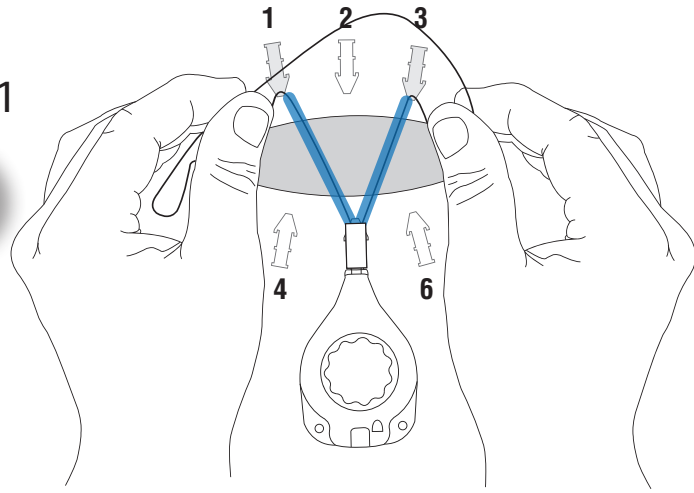

Using both hands, grasp the tension line near the front of the tension controller and with the first movement form the letter **V** by going around the tabs of anchors #1 and #3.

STEP 2

M

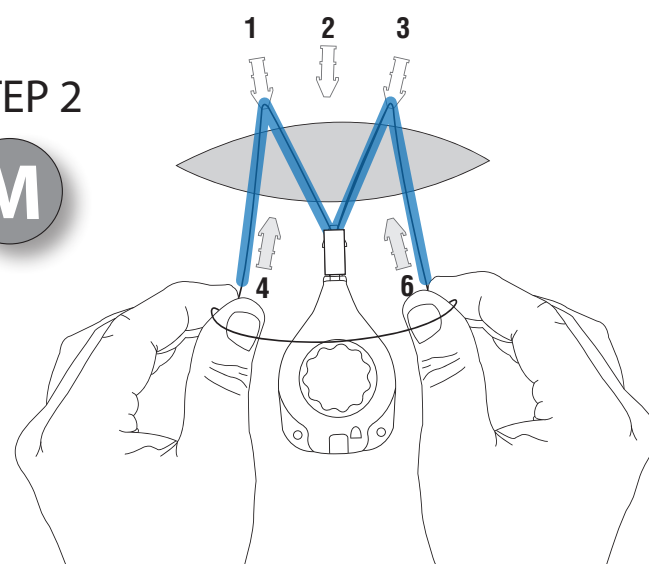

With the next movement form the letter **M** by guiding the tension line around tabs #4 and #6.

STEP 3

W

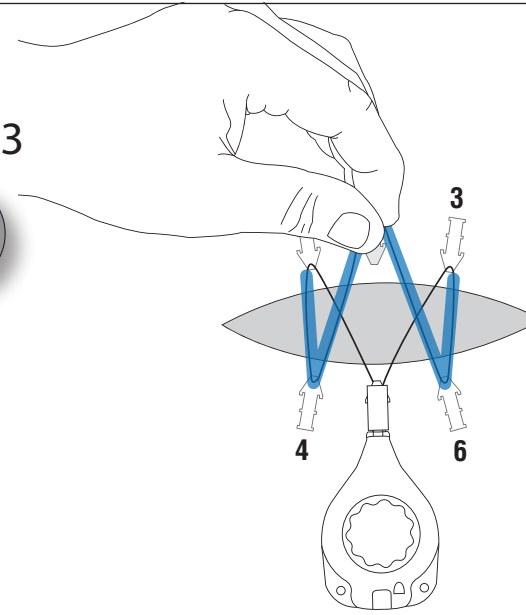

Holding the tension line with one hand, guide line over anchor tab #2 opposite the tension controller, completing the letter **W**. Gently pull back on the tension controller to remove any slack in the line. Turn blue control knob clockwise until audible clicking is heard (approx. 22 half rotations).

To Pull Out Tension Line

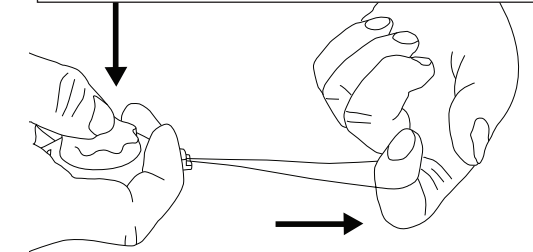

Press down on the center of the tension controller knob while pulling the line out with the other hand. It may be helpful to press the blue knob in and out.

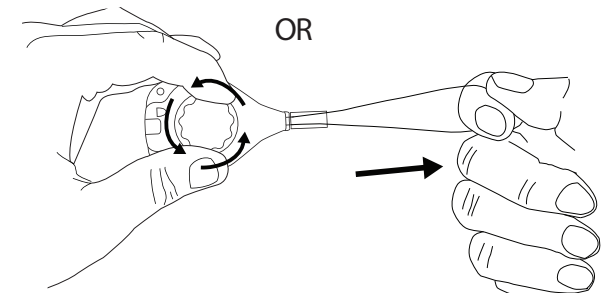

Turn the blue knob counter-clockwise while pressing down on the knob.

Prevent Loop or Eyelet

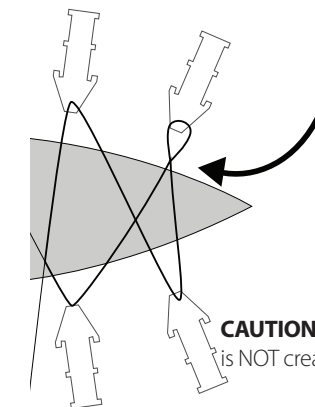

CAUTION: Be sure that a loop or eyelet is NOT created in the tension line.

DERMACLOSE device Shoelace Technique Guide

1. Supra fascial undermining of the wound margins approximately half the width of the wound is recommended.
2. Close distal and proximal ends of the wound as clinically indicated prior to positioning skin anchors.
3. Position tips of skin anchors approximately 0.5 to 1 cm from wound edge and a maximum of 2 cm apart

INDICATIONS FOR USE: The DERMACLOSE Continuous External Tissue Expander is indicated for use in assisting with the closure of moderate to large surgical or traumatic acute full thickness wounds of the skin by approximating and reducing the size of the wound.

CONTRAINDICATIONS: The DERMACLOSE Continuous External Tissue Expander should not be used on ischemic, infected, or acute burned tissue. It should not be used on fragile tissue at the edges of a wound.